



## RZ 自定心卡盘系列软卡爪

产品特点（以下参数按照环球卡盘卡爪标准整理）：

该系列卡爪用于 K10、K11、K12 系列卡盘，可按照用户要求提供各种规格的软卡爪；软卡爪包括整体软爪和 A 型分离式软爪以及 C 型分离式软爪。

整体式软爪：

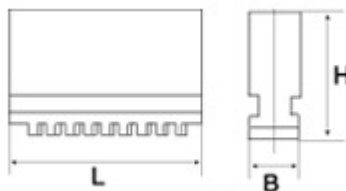

型号规格	RZ11-80	RZ11-100	RZ11-125	RZ11-160	RZ11-165	RZ11-200	RZ11-250	RZ11-315	RZ11-320	RZ11-325	RZ11-380
RZ-L	32	42	56	70	70	85	105	130	130	130	130
RZ-B	12	15	16	18.5	18.5	22	27	36	36	36	36
RZ-H	32	38	45	54	54	61	69	91	91	91	91

A 型分离式软顶爪：

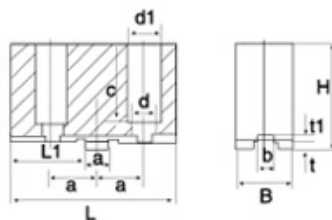
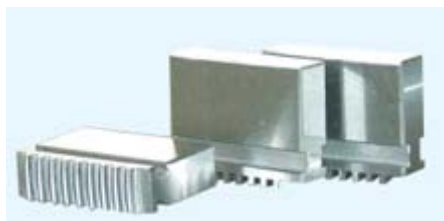

型号规格	L	L1	B	H	a	b	e	t	t1	c	d	d1
RZ11-160A	74	36	25	47	12.675	7.94	19	3	4	36	11	17
RZ11-200A	90	43	30	55	12.675	7.94	19	3	4	36	11	17
RZ11-250A	110	50	36	63	19.025	12.7	27	3	4	50	13	20
RZ11-315A	120	57	45	70	19.025	12.7	31.75	3	4	54	13	50
RZ11-320A	120	57	45	70	19.025	12.7	31.75	3	4	54	13	50
RZ11-325A	135	67	45	85	19.025	12.7	38.1	6	4	66	18	26
RZ11-380A	135	67	45	85	19.025	12.7	38.1	6	4	66	18	26
RZ11-400A	135	67	45	85	19.025	12.7	38.1	6	4	66	18	26
RZ11-500A	160	80	50	60	19.025	12.7	38.1	6	4	68	22	32



C 型分离式软顶爪:

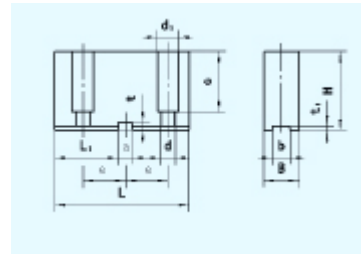
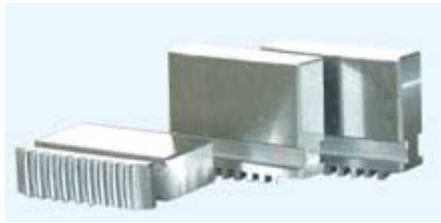

型号规格	L	L1	B	H	a	b	e	t	t1	c	d	d1
RZ11-200C	93	46	25	50	13	11	28	7	3	39	9	15
RZ11-240C	113	58	27	58	13	13	35	7	3	48	11	17
RZ11-250C	113	58	27	58	13	13	35	7	3	48	11	17

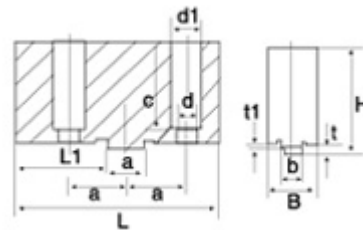
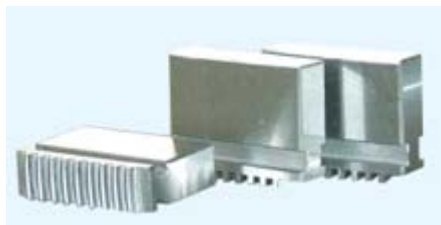

型号规格	L	L1	B	H	a	b	e	t	t1	c	d	d1
RZ11-320C	137	64	36	75	28	15	44	7.5	2.8	60.5	13	20
RZ11-325C	137	64	36	75	28	15	44	7.5	2.8	60.5	13	20
RZ11-380C	137	64	36	75	28	15	44	7.5	2.8	60.5	13	20